

SERIE 44-4000

Trykkreduserende regulator

44-4000
 Serie 44-4000

- Maks inngangstrykk: 414 bar
- Maks utgangstrykk: 103 bar
- Cv: 0,7, 2,0, 0,35
- Lekkasjeetthet: bobletett
- Husmateriale: AISI 303 rustfritt stål, AISI 316 rustfritt stål, messing, forkrommet messing



PRODUKTBESKRIVELSE

Applikasjoner

- Dykkeapplikasjoner for nødluftsystemer

Fordeler

- Høy flow: Cv = 0,7 eller 2,0 (opsjon)
- Stempelføler
- Justerbar i ulike bias-trykkområder
- Innkapslet ventilering
- Kompatibel med Tescom luftaktuatorer og ER5000 elektropneumatiske regulatorer

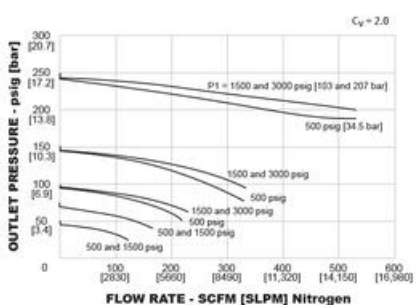
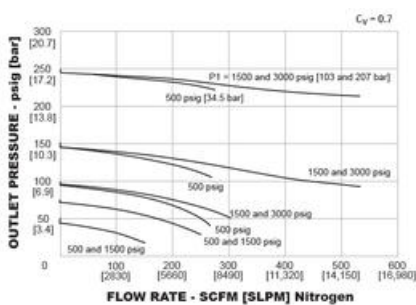

Example for selecting a part number:

44-40	1	9	E			2		12	DAL	MODIFICATION OPTION
			SOFT GOODS	SEAT	GASKET	TEMPERATURE*	INLET AND OUTLET PORT TYPE			
44-40	1 - Brass 2 - 303 Stainless Steel 6 - 316 Stainless Steel 9 - Chrome-plated Brass	1 - 100 psig 8 - 600 psig 2 - 200 psig 3 - 200 psig 4 - 120-180 psig 8 - 2.5-10.5 bar 9 - 0-15 psig	E - FM M - Styrene P - FRM Polymide Perfluoropolymer (Kurex®) V - FRM	PCFE PCFE PCFE PCFE PCFE PCFE	PCFE PCFE PCFE PCFE PCFE PCFE	-15 to 165 F -20 to 74 C -60 to 180 F -80 to 74 C 0 to 165 F -17 to 400 F -15 to 400 F -20 to 200 C	8 - ROP 1 - SAE 2 - NPT 3 - MSL3049	8 - 1/2 12 - 3/4 NPT 2 - 1/4 3 - MSL3049	2.00 2.00 0.35 0.35	002 - Cv = 2.0

44-40	1	9	E			2		12	DAL	MODIFICATION OPTION
			SOFT GOODS	SEAT	GASKET	TEMPERATURE*	INLET AND OUTLET PORT TYPE			
44-40	1 - Brass 2 - 303 Stainless Steel 6 - 316 Stainless Steel	8 - 600 psig 2 - 100 psig 9 - 100 psig	A - Nitril E - FRM M - Styrene P - FRM Polymide Perfluoropolymer (Kurex®) V - FRM	Nitril PCFE PCFE PCFE PCFE PCFE PCFE	PCFE PCFE PCFE PCFE PCFE PCFE	-60 to 165 F -20 to 74 C -15 to 165 F -20 to 74 C -20 to 74 C -20 to 74 C -20 to 200 C	8 - ROP 1 - SAE 2 - NPT 3 - MSL3049	8 - 1/2 12 - 3/4 2 - 1/4 3 - MSL3049	0.35 0.35 0.35	002 - Cv = 2.0

* Brass body is limited to +200 F (93 C) maximum.

PANEL MOUNT DIMENSIONS

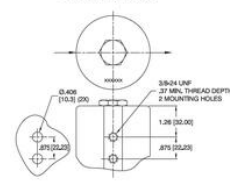

DOME LOAD/SPRING BIAS

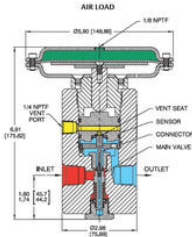
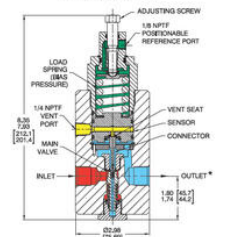

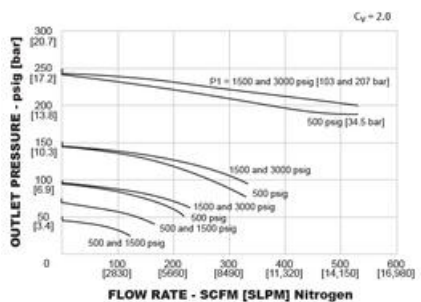
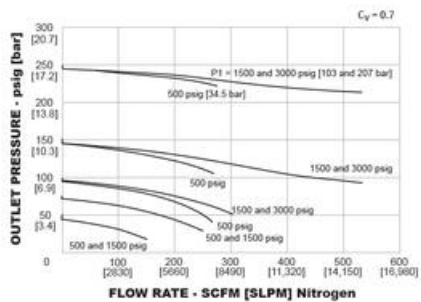

Example for selecting a part number:

44-40 DOME LOAD/SPRING BIAS

BANK SERIES	BODY MATERIAL	MAXIMUM INLET PRESSURE	SOFT GOODS		INLET AND OUTLET PORT TYPE		VALVE DIA. INCH	MODIFICATION OPTIONS
			O-RING SEAT	GASKET TEMPERATURE*	1	2		
44-40	1 - Brass 2 - 303 Stainless Steel 4 - 316 Stainless Steel 9 - Chromalloy Brass	1 - 100 psig 6.9 bar 2 - 200 psig 13.8 bar 3 - 350 psig 24.1 bar 4 - 120-150 psig 8.3-10.3 bar 9 - 0-15 psig 0-1.0 bar	A - FKM (Viton®) M - Ethylene Polymer P - FFKM Perfluoroelastomer (Kalrez®) V - FKM (Viton®)	PCITE PCITE PCITE PCITE Polyamide (Dynalene®) Polyamide (Dynalene®) Polyamide (Dynalene®)	-15° to 165° F -26° to 74° C -40° to 165° F -40° to 74° C -17° to 165° F -17° to 74° C -15° to 400° F -26° to 204° C	8 - BSP 1 - SAE 2 - NPT 3 - NCS1369	8 - 1/2" 12 - 3/4" NPT 2.86" 3.48"	482 - $C_v = 2.0$

AIR LOAD

BANK SERIES	BODY MATERIAL	INLET PRESSURE	SOFT GOODS		INLET AND OUTLET PORT TYPE		VALVE DIA. INCH	MODIFICATION OPTIONS
			O-RING SEAT	GASKET TEMPERATURE*	1	2		
44-40	1 - Brass 2 - 303 Stainless Steel 4 - 316 Stainless Steel	8 - 600 psig 51.7 bar 9 - 1500 psig 103 bar	A - Viton® M - Ethylene Polymer P - FFKM Perfluoroelastomer (Kalrez®) V - FKM (Viton®)	PCITE PCITE PCITE PCITE Polyamide (Dynalene®) Polyamide (Dynalene®) Polyamide (Dynalene®)	-40° to 165° F -40° to 74° C -15° to 165° F -26° to 74° C -40° to 165° F -40° to 74° C	8 - BSP 1 - SAE 2 - NPT 3 - NPT	8 - 1/2" 12 - 3/4" 2.86" 3.48"	484 - Air load $C_v = 0.7$ 485 - Air load $C_v = 2.0$

* Gross body is limited to +200 °F (93 °C) maximum.

PANEL MOUNT DIMENSIONS

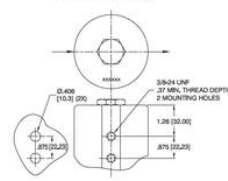

DOME LOAD/SPRING BIAS

