

SERIE 44-3200

Trykkreduserende regulator

44-3200
 Serie 44-3200

- Maks inngangstrykk: 207 bar
- Maks utgangstrykk: 13,8 bar
- Temperaturområde: -40 til 60 °C
- Cv: 1,0, 1,8
- Lekkasjeetthet: boblett, < 2 x 10⁻⁸ atm cc/sek He



PRODUKTBESKRIVELSE

Applikasjoner

- Laboratorie- og point of use-gassystemer
- Laserstøtte- og resonatorgasser
- Glovebox og isolatorer

Fordeler

- Tilgjengelig i AISI 316 rustfritt stål og messing
- Flere alternativer for inngangstrykk: 34,5 eller 207 bar
- Metall mot metall membranetning for redusert diffusjon
- Fem ulike utgangstrykkområder
- Manometerporter som standard
- Høyflow-modell tilgjengelig (Cv = 1,8)
- Mulighet for panelmontasje
- Ikke-ventilerende som standard
- Kan leveres med flenstilkoblinger

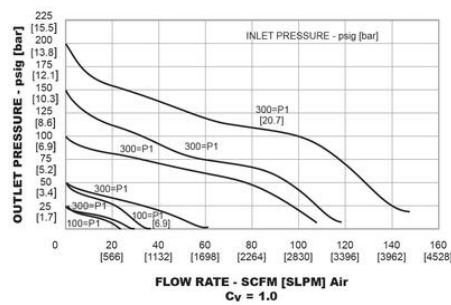
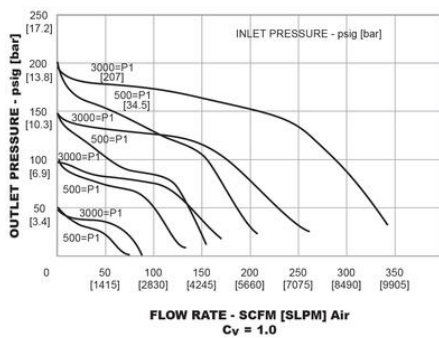

Threaded End Connection Part Number Selection

44-32	6	1	1	2	8	1		
BASIC SERIES	BODY MATERIAL	OUTLET PRESSURE RANGES	SEAT	SOFT GOODS SEAL	INLET AND OUTLET PORT TYPE	INLET AND OUTLET PORT SIZE	MAXIMUM INLET PRESSURE	OPTIONS
44-32	1 = Brass 6 = 316 Stainless Steel	0 = 0.25 psig 1 = 0.5 bar 2 = 0.100 psig 3 = 0.150 psig 4 = 0.200 psig 100=P1 300=P1	H = PTFE J = PC/PE	PTFE, O-ring PTFE, Spring Energizing Seal	2 = NPT 8 = 1/8"	1 = 100 psig 2 = 100 bar 3 = 100 psig 35.3 bar	401 = One 1/4" gauge port at 90° Cv = 1.8 402 = No gauge ports 206 = One 1/4" gauge port at 90° Cv = 1.8	

Flanged End Connector Part Number Selection:

44-32W	6	2	1	8	1	52	1				
BASIC SERIES	BODY, PIPE & FLANGE MATERIAL	OUTLET PRESSURE RANGES	DASH NO.	FLOW CAPACITY	SEAT	SEAL	OPERATING TEMPERATURE	GAUGE PORT OPTIONS	FLANGE SIZE	FLANGE CLASS	FLANGE FACE
44-32W	6 - 316 SS	0 - 0.75 psig 0 - 1.3 bar	1	1.0	PC/TIT	PTFE	-30 to 180°F -29 to 66°C	A - 1/8" Inlet, no gauge port	1 - 1/2"	11 - 150#	1 - RT
		1 - 0.50 psig 0.3 bar						B - 3/4" Inlet, 1/8" gauge port at 60°	3 - 1"	21 - 300#	2 - RT
		2 - 0.100 psig 0.6.9 bar						J - 1/4" Inlet, 1/8" gauge port at 90°		52 - 900# / 150#	
		3 - 0.150 psig 0.10.3 bar								63 - 750#	
		4 - 0.200 psig 0.13.8 bar									

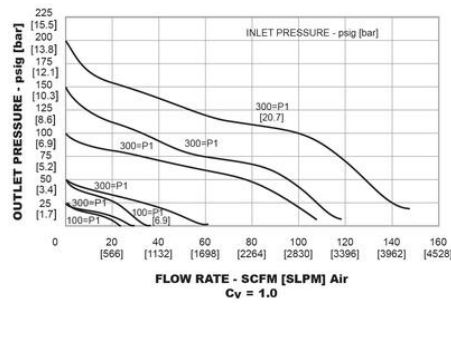
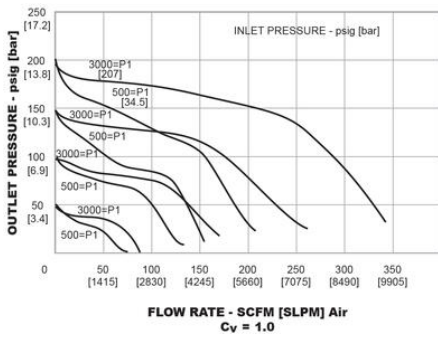
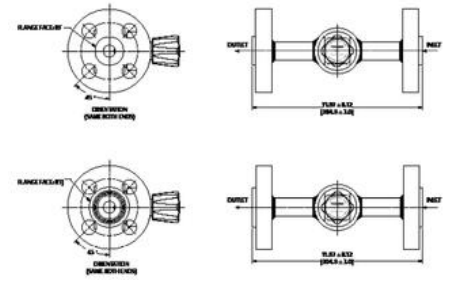
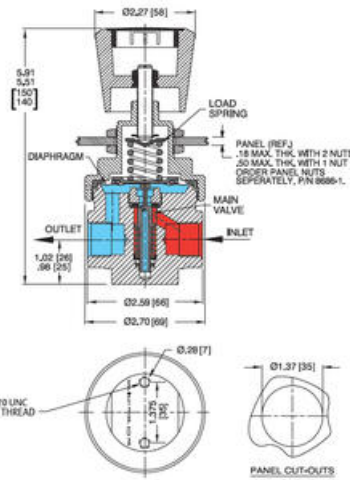
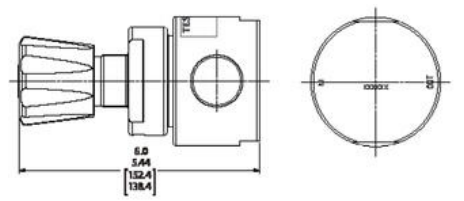
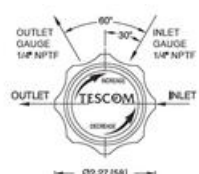

Threaded End Connector Part Number Selection:

44-32	6	1	J	2	8	1	1	
BASIC SERIES	BODY MATERIAL	OUTLET PRESSURE RANGES	SEAT	SEAL	INLET AND OUTLET PORT TYPE	INLET AND OUTLET PORT SIZE	MAXIMUM INLET PRESSURE	OPTIONS
44-32	1 - Brass 6 - 316 Stainless Steel	0 - 0.75 psig 0 - 1.3 bar 1 - 0.50 psig 0.3 bar 2 - 0.100 psig 0.6.9 bar 3 - 0.150 psig 0.10.3 bar 4 - 0.200 psig 0.13.8 bar	M - PTFE J - PC/TIT	PTFE (O ring) PTFE Spring Energized lip seal	2 - NPT	1/2 - 1/2" 1 - 1/2"	1 - 300 psig 207 bar 3 - 100 psig 6.9 bar	401 - One 1/8" gauge port at 90° Cv = 1.8 403 - No gauge ports 405 - One 1/8" gauge port at 90° Cv = 1.8

Flanged End Connector Part Number Selection:

44-32W	6	2	1	8	1	52	1				
BASIC SERIES	BODY, PIPE & FLANGE MATERIAL	OUTLET PRESSURE RANGES	DASH NO.	FLOW CAPACITY	SEAT	SEAL	OPERATING TEMPERATURE	GAUGE PORT OPTIONS	FLANGE SIZE	FLANGE CLASS	FLANGE FACE
44-32W	6 - 316 SS	0 - 0.75 psig 0 - 1.3 bar	1	1.0	PC/TIT	PTFE	-30 to 180°F -29 to 66°C	A - 1/8" Inlet, no gauge port	1 - 1/2"	11 - 150#	1 - RT
		1 - 0.50 psig 0.3 bar						B - 3/4" Inlet, 1/8" gauge port at 60°	3 - 1"	21 - 300#	2 - RT
		2 - 0.100 psig 0.6.9 bar						J - 1/4" Inlet, 1/8" gauge port at 90°		52 - 900# / 150#	
		3 - 0.150 psig 0.10.3 bar								63 - 750#	
		4 - 0.200 psig 0.13.8 bar									

