

Temperaturområde til

120 °C

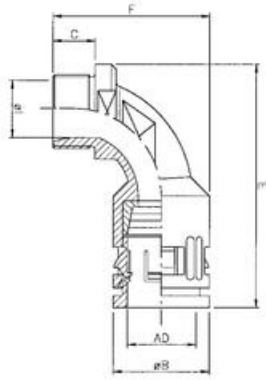

	AD	Ø1	ØB	C	F	E
PG 7	10,0	6,5	17,0	10,0	39,0	56,9
PG 9	13,0	8,5	20,0	12,0	40,5	59,2
PG 11	15,8	10	23,0	12,0	44,6	61,8
PG 13,5	18,5	12,5	25,0	12,0	46,8	64,0
PG 16	21,2	14,5	29,5	13,0	48,1	73,2
PG 21	28,5	20	37,0	14,0	64,1	84,8
PG 29	34,5	29	44,0	14,0	74,0	100,6
PG 36	42,5	36	52,0	17,0	82,4	111,0
PG 48	54,5	45,5	64,0	17,0	97,2	124,3